

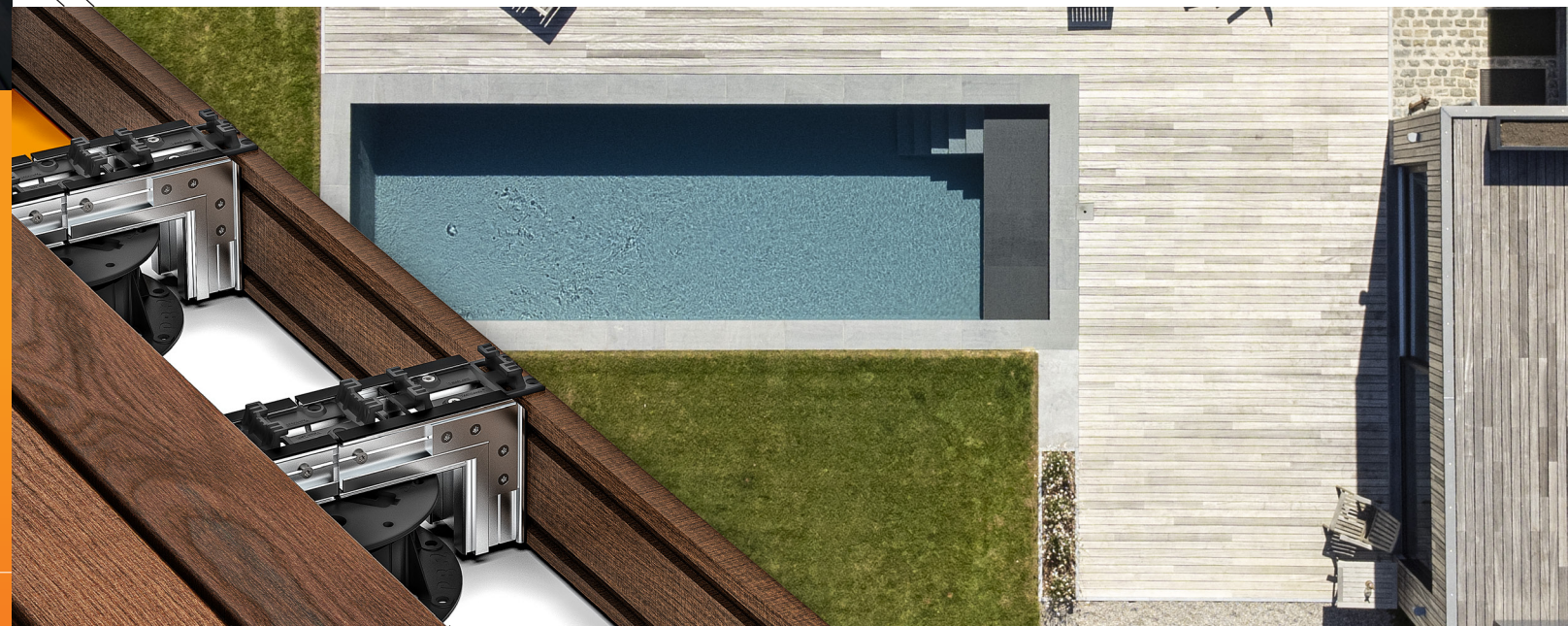

FOR MORE THAN 20 YEARS, THE VETEDY GROUP HAS SPECIALIZED ITSELF IN THE MANUFACTURE OF DECKING AND CLADDING SYSTEMS WITH INVISIBLE FIXATION.

Technideck®

100% INVISIBLE. FAST. SUSTAINABLE.



Technideck®, AN INTUITIVE DECKING SYSTEM WITH 100% INVISIBLE FIXATION ON ALUMINIUM STRUCTURE.

The VETEDY Group has experienced an exponential growth following the development of its *Softline*® system which was the first complete system for wooden decks without visible screws.

Today, VETEDY is a family owned group with an international dimension, present all over the world in Luxembourg, Belgium, Cameroon and Indonesia.

VETEDY is the creator, producer and owner of the *Softline*® and *Technideck*® systems for decking and *Techniclic*® system for cladding; three high qualitative systems having demonstrated their technicality, durability and precision over the years.

Technideck®

CONTACT

Tel : (+352) 26 30 61 1
Fax: (+352) 26 30 61-61
info@vetedy.com

FOLLOW "VETEDY GROUP"



VETEDY LUXEMBOURG S.A.

39 route d'Arlon
L-8410 STEINFORT
GRAND-DUCHÉ DE LUXEMBOURG

VETEDY BELGIUM S.A.

50 zone artisanale de Weyler
B-6700 ARLON
BELGIQUE

VETEDY CAMEROUN S.À R.L.

BP 4363 NLONGKAK
YAOUNDE
CAMEROUN

PT VETEDY INDONESIA

GRESIK
SURABAYA INDONESIA

www.vetedy.com

It is an international organization composed of organizations' representatives of environmental protection, organizations defending the rights of indigenous peoples, forest and wood products dealers. By adhering to this charter, the Vetedy Group affirms its commitment to ensuring the preservation of our nature and attaches particular attention to respect for the rational management of natural resources and the equitable distribution of income in the country of production.



Technideck® 100% INVISIBLE. FAST. SUSTAINABLE.

Technideck® is a unique and complete decking system with 100% invisible fixings on aluminum structure. It is the result of many years of research and development which combine the experience of the Softline® decking and the Techniclic® cladding. This new process composed of pre-mounted clips on aluminum joists will allow you to considerably reduce the installation time of your decking.



- A** Deck boards
- B** Clips
- C** EPDM seal
- D** Technideck® Joist
- E** Joist spacer
- F** Bracket
- G** Flat bracket

The systems designed by Vetedy have always advocated 100% invisible fixations: no visible screws for a deck made of wood only. The Technideck® system has been thought out and designed for a quick and easy installation thanks to its unique patented clip and very few other accessories needed to achieve all kinds of finishings without visible fixings. This technical set, made of aluminum and composite material, has been developed in such a way as to sustainably face all climatic and mechanical stresses.

ONE-CLIC FIXATION

Directly on the pedestal



Buzon® clic

Intra joist connectors that ensure a continuous link

INFINITE LENGTHS

"PERFECT-FIT" SYSTEM

Joist spacer system for a fixed and precise eye-to-eye distance

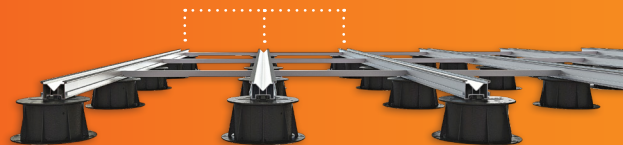

LAID & FIXED

Only 2 different brackets for all finishing types



Technideck® COVERINGS. STABLE & SUSTAINABLE.

The Technideck® aluminum joist system has been designed to be able to fix the new Technideck® boards sizes and wooden species but also the whole Softline® range, the system which have made Vetedy's success and reputation.

OUR SELECTED WOOD SPECIES

Type	Section	Lengths	Profiles	Axis-to-axis	
	Padouk	20x100	800 - 2400	SL	400
	Thermo-ash	25x140	1000 - 2500	TD	500
	Bamboo C-TECH	20x140	1850	TD	462,5
	Cumaru Blondo	20x100	800 - 2400	SL	400
	Merbau	20x100	800 - 2400	SL	400
		25x140	1000 - 2500	TD	500
	Ipe	20x100	800 - 2800	SL	400
	Accoya® Color(gray)	20x140	800 - 2800	SL	400
	Accoya® Natural	20x140	800 - 2800	SL	400
	Kebony® Clear	20x140	800 - 2800	SL	400

TONGUE & GROOVE SYSTEM

The boards are delivered with a T&G system for a perfect junction at the end of the boards.

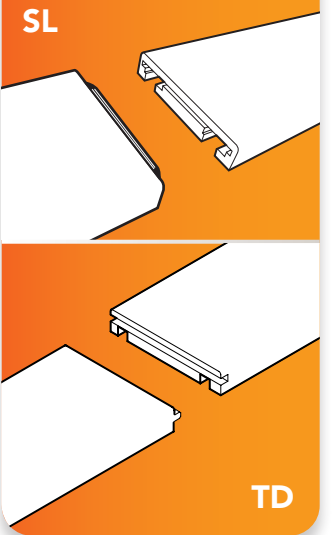

*SL - Softline®, TD - Technideck®

N.B.: dimensions in mm

PATENTED MOUNTING PRINCIPLE

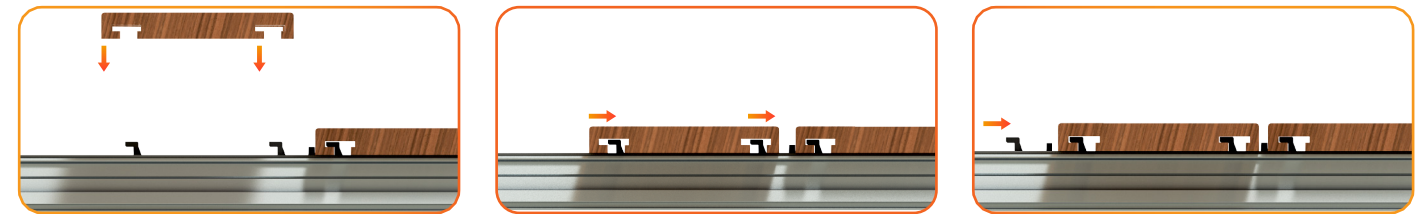

THE ADVANTAGES OF THE Technideck® SYSTEM

- Stable and durable aluminum structure
- Regular and automatic space along the boards
- Surface & finishings fixed with 100% hidden fastening
- Avoided bending of the boards thanks to the plank dimensions and the adapted to KD drying process
- Considerable saving of installation time thanks to the technology and the pre-assembled clips
- Insulation of the planks from the support and sound insulation thanks to the pre-assembled EPDM gasket
- Fixation in high performance composite material
- Free air circulation between the planks and the structure following the strictest official standards
- Flexibility of the clip allowing it to follow the movements of the wood (unlike steel)
- Decking frames and trims with one unique invisible fixation clip
- Quick and easy board replacement
- ... and many others, which all put together provide you a durable, aesthetic and unique decking in all serenity for many years.